

# BCMA Series

## FEATURES

- Common mode filter or Signal Line
- AEC-Q200 qualified
- Quantity: 2000 pcs

## APPLICATION

Part No		Tol

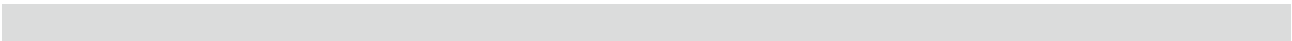
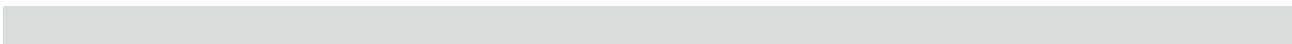
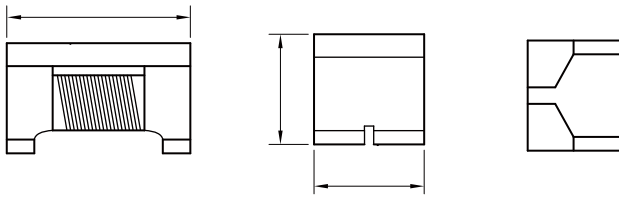

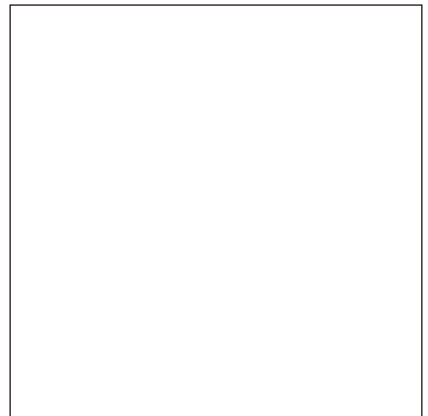
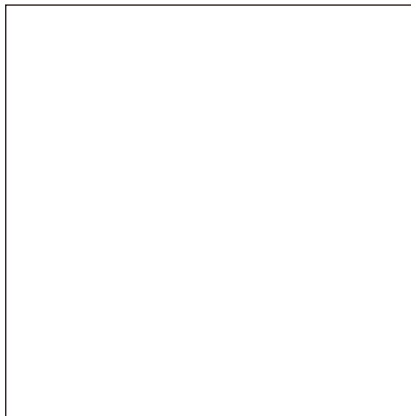
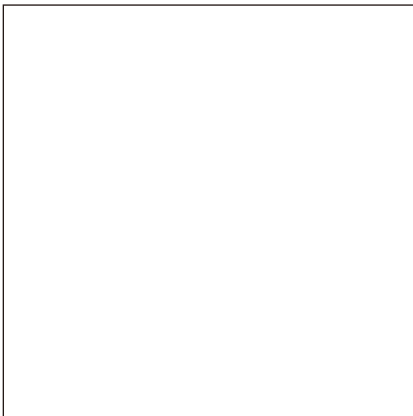
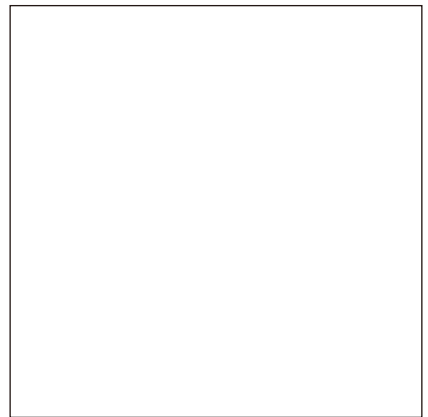
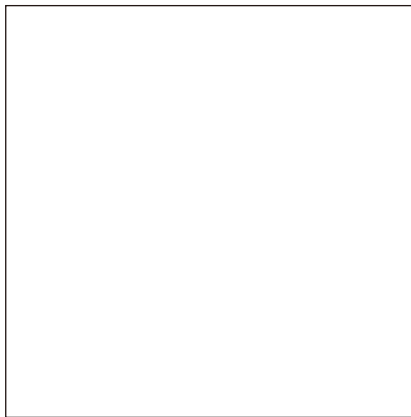
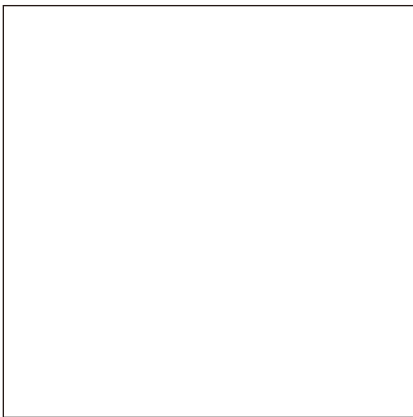
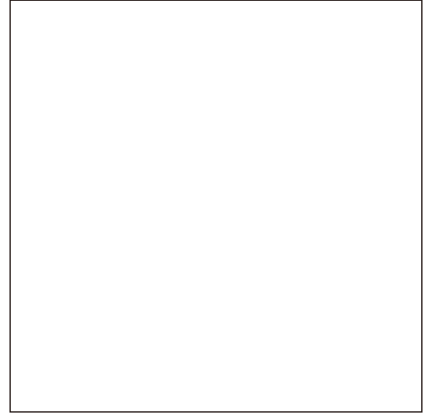
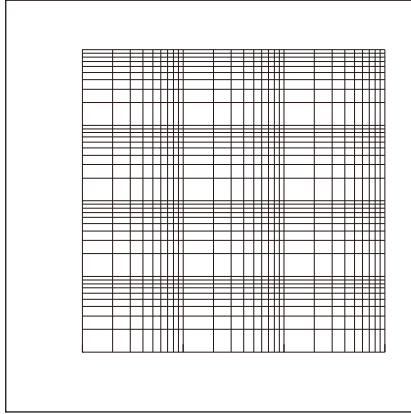
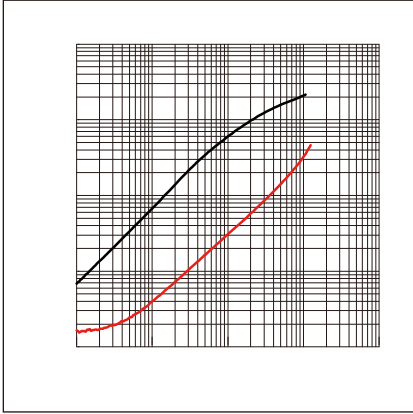

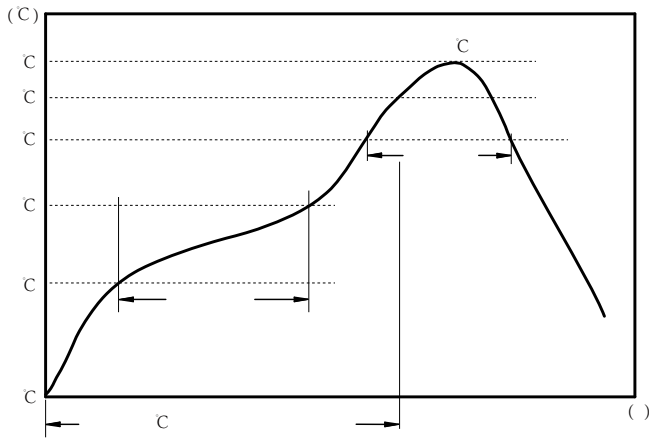

c  
c  
c

:

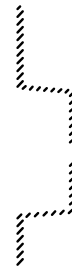
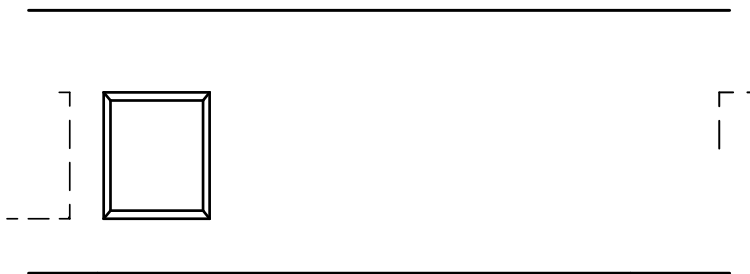

BCMA2012	1.50±0.1	2.35±0.1	1.5±0.1	4.0±0.1	4.0±0.1	8.0±0.3	1.45±0.1	1.75±0.1	0.22±0.05

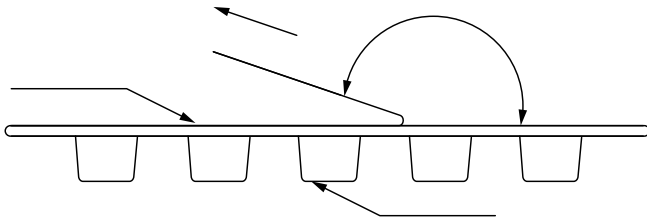

The peel force of top cover tape shall be between 0.14 to 0.78 N

:

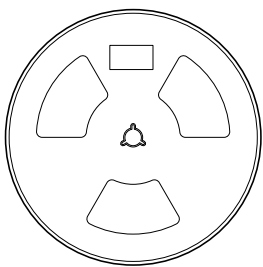
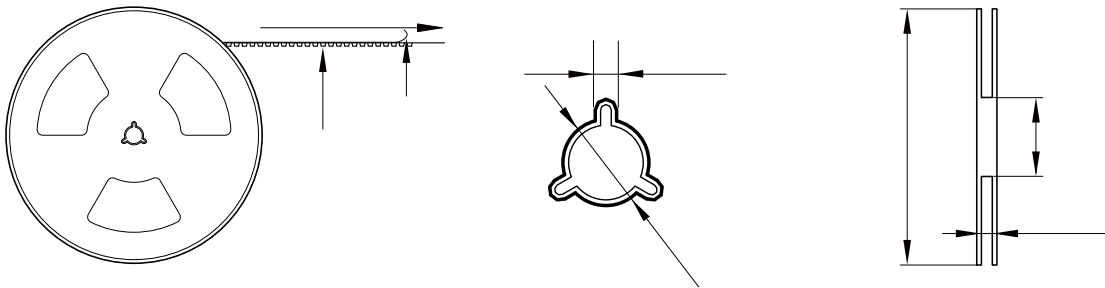

2000 Pcs/Reel

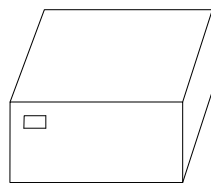

5 Reel /Inner box( 10K Pcs)

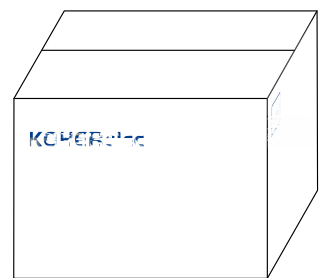

8 Inner box/Carton box(80K Pcs)

:

•

•

•

•

•

•

•

•